

Instruction of Using Veterinary SpO₂ Probes

Choosing Veterinary SpO₂ Probe

PC-66V Handheld Pulse Oximeter is equipped with special probes for monitoring animals. Now two types of SpO₂ probes with three kinds of adapters are provided, one is the “Y” type probe with clear coating on the sensor, which is suitable for big animals or where the tissue is thick or dark, the other one is the “Y” type probe with opaque coating on the sensor, which is suitable for small animals or where the tissue is thin or transparent. The three kinds of probe adapters are big clip, small clip and rubber wrapper respectively, which can be used on different measuring site accordingly, such as tongue, ear, leg or tail. Please choose the appropriate probe and adapter according to its character and the measuring site.

SpO₂ Probe Connection

Connection of Big Clip

1. Take off the two rubber jackets from the clip;
2. Fix the sensor cable to the clip (**Fig. 1**);
3. Slide one sensor (the side with coating inward) into the fixing slot from the clip opening to the stop at the end of the slot (**Fig. 2**), and then fix the other sensor.
4. Install the two rubber jackets to the clip (**Fig. 3**).

Connection of Small Clip

Follow the step 1, step 2 and step 4 mentioned in Section Connection of Big Clip and refer to **Fig. 4** and **Fig. 5**.

Connection of Rubber Wrapper

1. Spread the rubber wrapper, there are two fixing slots (**Fig. 6**).
2. Hold the rubber wrapper and press the sensor into one of the fixing slots (**Fig. 7**), then fix the other sensor.

Note: following the connecting procedure in reverse to detach the sensor and do not pull it with force.

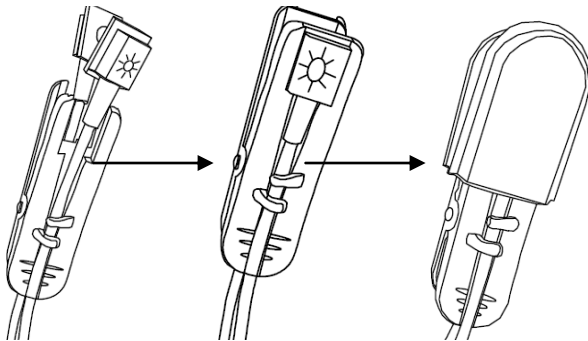

Fig. 1

Fig. 2

Fig. 3

Big Clip Connection

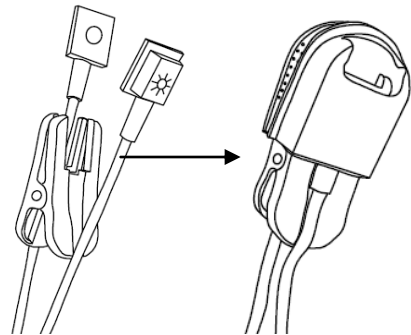

Fig. 4

Fig. 5

Small Clip Connection

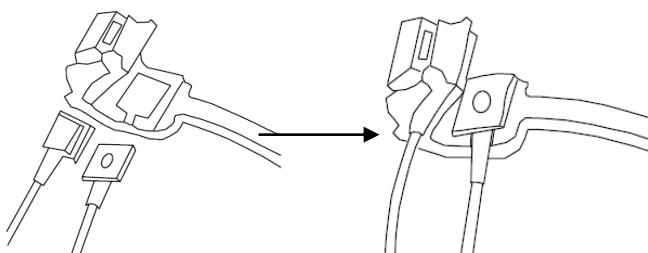
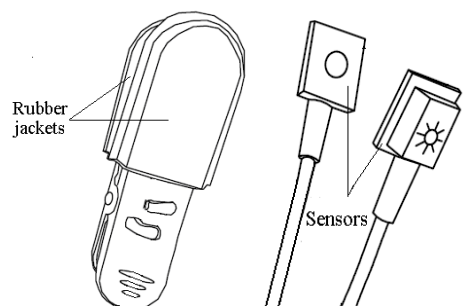

Fig. 6

Fig. 7

Rubber Wrapper Connection



Clip and Sensor

Instruction of Using Veterinary SpO₂ Probes

Placement of Veterinary SpO₂ Probe

As a general rule, measuring SpO₂ for animals is performed when the animal is under anaesthesia, and the optimal measuring site is their tongues. Normally the animal's tongue will slip out after anaesthesia. At first, clip the probe on its tongue (**Fig. 8**). Then, according to perfusion index (PI) value (greater PI is better) you can find an appropriate site.

Besides the tongue, you can clip or wrap the SpO₂ sensor onto other places such as legs or tail (**Fig.9**). Since animal hair will decrease the sensitivity or even make the measurement failure, please always choose the place with less hair under the sensor. If necessary, shave off the hair on the measuring site.

Tips for SpO₂ Monitoring

If there is strong ambient light interference, you can use opaque thing to cover the measuring site and the probe. By doing so, measurement distortion may be avoided.

The lights including surgery lamp, halogen lamp, fluorescent lamp and infrared heating lamp can also cause measurement distortion. In such condition, you can use solid black thing to cover the measuring site and the probe.

If PI value is less than 1%, the probe with clear coating on the sensor is recommended for a better measurement result.



Fig. 8

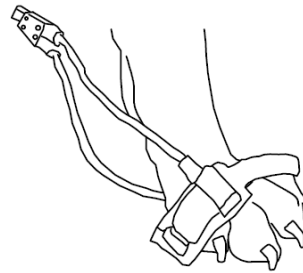



Fig. 9

Amendment to PC-66B User Manual

Dear Users,

The operation and software of PC-66V are almost the same as PC-66B, but there are some differences, so the corresponding information in PC-66B User Manual needs to be amended for your use. Details read as follows.

1) The following information will be added to Section 4.5:

On the above mentioned screens, longtime press “

- **SETUP:** set parameter values. Refer to Section 4.5 for detailed setup operations.
- **UPLOAD DATA:** reserved for future use.
- **VERSION:** display version information.

Select the item “SETUP”, “UPLOAD DATA”, or “VERSION” with Navigation Key, then press “

2) Pulse Rate detecting range can be selected, so the Figure 10 Menu Setup Screen (C) in section 4.5 is replaced with the following figure:

ALARM-PR LO	50
PR RANGE	25~200
PULSE SOUND	ON
REC INTERVAL	11s



Fig. 10 Setup Screen (C)

4) Brief Comparison between PC-66V and PC-66B Handheld Pulse Oximeters

Performance Differences between PC-66V and PC-66B		
Model	PC-66V	PC-66B
SpO ₂ sensor (photodetector)	Photodiode	Light-frequency converter
SpO ₂ probe type	“Y” type probes with clear and opaque coating on 2 different sensors, adapters of big, small clips and rubber wrapper are provided.	Reusable adult and pediatric clip probes, disposable neonatal Y-type probes with wrapper.
PR measuring range	30-400bpm	30-240bpm
PR range selection	Low end: 25~200bpm High end: 120~410bpm	Full range: 30-240bpm
Intended use for	Animals or human	Human

- **PR RANGE:** choose the pulse rate range. Two options: 25~200 (bpm) or 120~410 (bpm).

Operation Instruction:

- Long time press  (Navigation key) to shift cursor continuously or increase/decrease numerical value (continuous);
- Short time press  (Navigation key) to shift cursor or increase/decrease numerical value (single time);

3) The following operation instruction will be added to section 4.6.1.

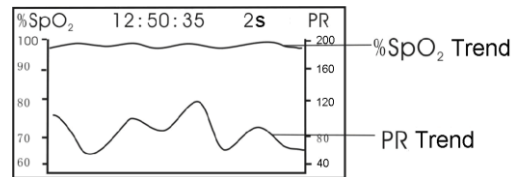

Trend Recall Screen

Operation Instruction:

On trend recall screen, if PR scale values show on the screen, but no PR trend, it means the PR value exceeds the current PR display range. There are two groups of PR scale range: “25~200” or “120~410”. Longtime press “